

RAYTOOLS® / BODOR®

POS	REFERENCE NUMBER	WALTH SKU	DESCRIPTION	PKG QTY
1		RB062001	RYT/BDR-NOZZLE Ø 0.8	1
		RB062001V	RYT/BDR-NOZZLE Ø 0.8 5PK	5
		RB062002	RYT/BDR-NOZZLE Ø 1.0	1
		RB062002V	RYT/BDR-NOZZLE Ø 1.0 5PK	5
		RB062003	RYT/BDR-NOZZLE Ø 1.2	1
		RB062003V	RYT/BDR-NOZZLE Ø 1.2 5PK	5
		RB062004	RYT/BDR-NOZZLE Ø 1.4	1
		RB062004V	RYT/BDR-NOZZLE Ø 1.4 5PK	5
		RB062005	RYT/BDR-NOZZLE Ø 1.5	1
		RB062005V	RYT/BDR-NOZZLE Ø 1.5 5PK	5
		RB062006	RYT/BDR-NOZZLE Ø 1.8	1
		RB062006V	RYT/BDR-NOZZLE Ø 1.8 5PK	5
		RB062007	RYT/BDR-NOZZLE Ø 2.0	1
		RB062007V	RYT/BDR-NOZZLE Ø 2.0 5PK	5
		RB062009	RYT/BDR-NOZZLE Ø 2.5	1
		RB062009V	RYT/BDR-NOZZLE Ø 2.5 5PK	5
		RB062011	RYT/BDR-NOZZLE Ø 3.0	1
		RB062011V	RYT/BDR-NOZZLE Ø 3.0 5PK	5
		RB062012	RYT/BDR-NOZZLE Ø 3.5	1
		RB062012V	RYT/BDR-NOZZLE Ø 3.5 5PK	5
		RB062013	RYT/BDR-NOZZLE Ø 4.0	1
		RB062013V	RYT/BDR-NOZZLE Ø 4.0 5PK	5
		RB062014	RYT/BDR-NOZZLE Ø 4.5	1
		RB062014V	RYT/BDR-NOZZLE Ø 4.5 5PK	5
		RB062015	RYT/BDR-NOZZLE Ø 5.0	1
		RB062015V	RYT/BDR-NOZZLE Ø 5.0 5PK	5

Walth Corporation is not affiliated with the named manufacturers. Reference to machines, parts, descriptions, and model numbers are for convenience in verifying compatibility only. All parts are made by or for Walth Corporation and are not made by the reference manufactures (unless expressly indicated). All other trademarks are the properties of their respective owners.

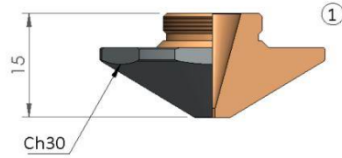

RAYTOOLS® / BODOR®

POS	REFERENCE NUMBER	WALTH SKU	DESCRIPTION	PKG QTY
1		RB062001C	RYT/BDR-NOZZLE Ø 0.8 CP	1
		RB062001CV	RYT/BDR-NOZZLE Ø 0.8 CP 5PK	5
		RB062002C	RYT/BDR-NOZZLE Ø 1.0 CP	1
		RB062002CV	RYT/BDR-NOZZLE Ø 1.0 CP 5PK	5
		RB062003C	RYT/BDR-NOZZLE Ø 1.2 CP	1
		RB062003CV	RYT/BDR-NOZZLE Ø 1.2 CP 5PK	5
		RB062004C	RYT/BDR-NOZZLE Ø 1.4 CP	1
		RB062004CV	RYT/BDR-NOZZLE Ø 1.4 CP 5PK	5
		RB062005C	RYT/BDR-NOZZLE Ø 1.5 CP	1
		RB062005CV	RYT/BDR-NOZZLE Ø 1.5 CP 5PK	5
		RB062006C	RYT/BDR-NOZZLE Ø 1.8 CP	1
		RB062006CV	RYT/BDR-NOZZLE Ø 1.8 CP 5PK	5
		RB062007C	RYT/BDR-NOZZLE Ø 2.0 CP	1
		RB062007CV	RYT/BDR-NOZZLE Ø 2.0 CP 5PK	5
		RB062009C	RYT/BDR-NOZZLE Ø 2.5 CP	1
		RB062009CV	RYT/BDR-NOZZLE Ø 2.5 CP 5PK	5
		RB062011C	RYT/BDR-NOZZLE Ø 3.0 CP	1
		RB062011CV	RYT/BDR-NOZZLE Ø 3.0 CP 5PK	5
		RB062012C	RYT/BDR-NOZZLE Ø 3.5 CP	1
		RB062012CV	RYT/BDR-NOZZLE Ø 3.5 CP 5PK	5
	RB062013C	RYT/BDR-NOZZLE Ø 4.0 CP	1	
	RB062013CV	RYT/BDR-NOZZLE Ø 4.0 CP 5PK	5	
	RB062014C	RYT/BDR-NOZZLE Ø 4.5 CP	1	
	RB062014CV	RYT/BDR-NOZZLE Ø 4.5 CP 5PK	5	
	RB062015C	RYT/BDR-NOZZLE Ø 5.0 CP	1	
	RB062015CV	RYT/BDR-NOZZLE Ø 5.0 CP 5PK	5	

Walth Corporation is not affiliated with the named manufacturers. Reference to machines, parts, descriptions, and model numbers are for convenience in verifying compatibility only. All parts are made by or for Walth Corporation and are not made by the reference manufactures (unless expressly indicated). All other trademarks are the properties of their respective owners.

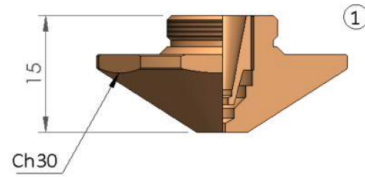

RAYTOOLS® / BODOR®				
POS	REFERENCE NUMBER	WALTH SKU	DESCRIPTION	PKG QTY
1		RB062021	RYT/BDR-DOUBLE NOZZLE Ø 0.8	1
		RB062021V	RYT/BDR-DOUBLE NOZZLE Ø 0.8 5PK	5
		RB062022	RYT/BDR-DOUBLE NOZZLE Ø 1.0	1
		RB062022V	RYT/BDR-DOUBLE NOZZLE Ø 1.0 5PK	5
	30205001514	RB062023	RYT/BDR-DOUBLE NOZZLE Ø 1.2	1
	30205001514	RB062023V	RYT/BDR-DOUBLE NOZZLE Ø 1.2 5PK	5
		RB062024	RYT/BDR-DOUBLE NOZZLE Ø 1.4	1
		RB062024V	RYT/BDR-DOUBLE NOZZLE Ø 1.4 5PK	5
		RB062025	RYT/BDR-DOUBLE NOZZLE Ø 1.5	1
		RB062025V	RYT/BDR-DOUBLE NOZZLE Ø 1.5 5PK	5
		RB062026	RYT/BDR-DOUBLE NOZZLE Ø 1.8	1
		RB062026V	RYT/BDR-DOUBLE NOZZLE Ø 1.8 5PK	5
		RB062027	RYT/BDR-DOUBLE NOZZLE Ø 2.0	1
		RB062027V	RYT/BDR-DOUBLE NOZZLE Ø 2.0 5PK	5
	30205001517	RB062029	RYT/BDR-DOUBLE NOZZLE Ø 2.5	1
	30205001517	RB062029V	RYT/BDR-DOUBLE NOZZLE Ø 2.5 5PK	5
		RB062031	RYT/BDR-DOUBLE NOZZLE Ø 3.0	1
		RB062031V	RYT/BDR-DOUBLE NOZZLE Ø 3.0 5PK	5
		RB062032	RYT/BDR-DOUBLE NOZZLE Ø 3.5	1
		RB062032V	RYT/BDR-DOUBLE NOZZLE Ø 3.5 5PK	5
	RB062033	RYT/BDR-DOUBLE NOZZLE Ø 4.0	1	
	RB062033V	RYT/BDR-DOUBLE NOZZLE Ø 4.0 5PK	5	
	RB062034	RYT/BDR-DOUBLE NOZZLE Ø 4.5	1	
	RB062034V	RYT/BDR-DOUBLE NOZZLE Ø 4.5 5PK	5	
	RB062035	RYT/BDR-DOUBLE NOZZLE Ø 5.0	1	
	RB062035V	RYT/BDR-DOUBLE NOZZLE Ø 5.0 5PK	5	

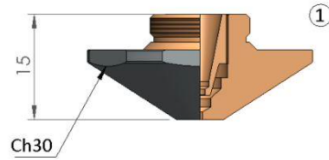

RAYTOOLS® / BODOR®				
POS	REFERENCE NUMBER	WALTH SKU	DESCRIPTION	PKG QTY
1		RB062021C	RYT/BDR-DOUBLE NOZZLE Ø 0.8 CP	1
		RB062021CV	RYT/BDR-DOUBLE NOZZLE Ø 0.8 CP 5PK	5
		RB062022C	RYT/BDR-DOUBLE NOZZLE Ø 1.0 CP	1
		RB062022CV	RYT/BDR-DOUBLE NOZZLE Ø 1.0 CP 5PK	5
		RB062023C	RYT/BDR-DOUBLE NOZZLE Ø 1.2 CP	1
		RB062023CV	RYT/BDR-DOUBLE NOZZLE Ø 1.2 CP 5PK	5
		RB062024C	RYT/BDR-DOUBLE NOZZLE Ø 1.4 CP	1
		RB062024CV	RYT/BDR-DOUBLE NOZZLE Ø 1.4 CP 5PK	5
		RB062025C	RYT/BDR-DOUBLE NOZZLE Ø 1.5 CP	1
		RB062025CV	RYT/BDR-DOUBLE NOZZLE Ø 1.5 CP 5PK	5
		RB062026C	RYT/BDR-DOUBLE NOZZLE Ø 1.8 CP	1
		RB062026CV	RYT/BDR-DOUBLE NOZZLE Ø 1.8 CP 5PK	5
		RB062027C	RYT/BDR-DOUBLE NOZZLE Ø 2.0 CP	1
		RB062027CV	RYT/BDR-DOUBLE NOZZLE Ø 2.0 CP 5PK	5
		RB062029C	RYT/BDR-DOUBLE NOZZLE Ø 2.5 CP	1
		RB062029CV	RYT/BDR-DOUBLE NOZZLE Ø 2.5 CP 5PK	5
		RB062031C	RYT/BDR-DOUBLE NOZZLE Ø 3.0 CP	1
		RB062031CV	RYT/BDR-DOUBLE NOZZLE Ø 3.0 CP 5PK	5
		RB062032C	RYT/BDR-DOUBLE NOZZLE Ø 3.5 CP	1
		RB062032CV	RYT/BDR-DOUBLE NOZZLE Ø 3.5 CP 5PK	5
		RB062033C	RYT/BDR-DOUBLE NOZZLE Ø 4.0 CP	1
		RB062033CV	RYT/BDR-DOUBLE NOZZLE Ø 4.0 CP 5PK	5
		RB062034C	RYT/BDR-DOUBLE NOZZLE Ø 4.5 CP	1
		RB062034CV	RYT/BDR-DOUBLE NOZZLE Ø 4.5 CP 5PK	5
		RB062035C	RYT/BDR-DOUBLE NOZZLE Ø 5.0 CP	1
		RB062035CV	RYT/BDR-DOUBLE NOZZLE Ø 5.0 CP 5PK	5

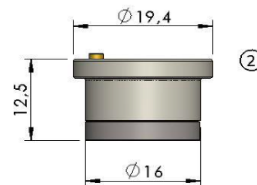
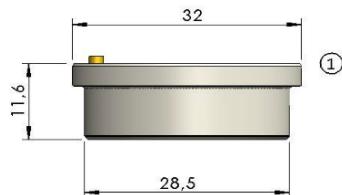

RAYTOOLS®				
POS	REFERENCE NUMBER	WALTH SKU	DESCRIPTION	PKG QTY
1	AO-NOZ-D00051	RY069002	RYT-CERAMIC NOZZLE HOLDER	1
2	31220000006	RY069003	RYT-CERAMIC NOZZLE HOLDER	1